

Drilling positions

1 hole 138x68 mm (5.43x2.67 in.)

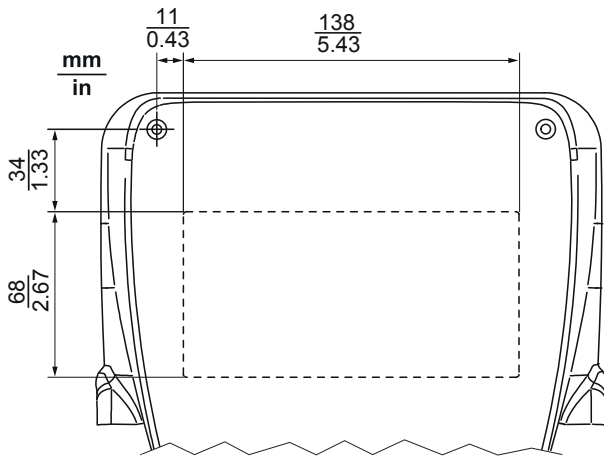

FRONT VIEW

4 holes 71x29 mm (2.79x1.14 in.)

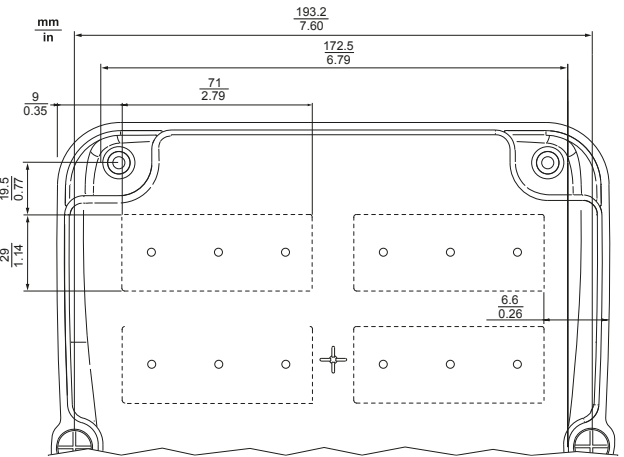

REAR VIEW

1 hole 71x29 mm (2.79x1.14 in.)

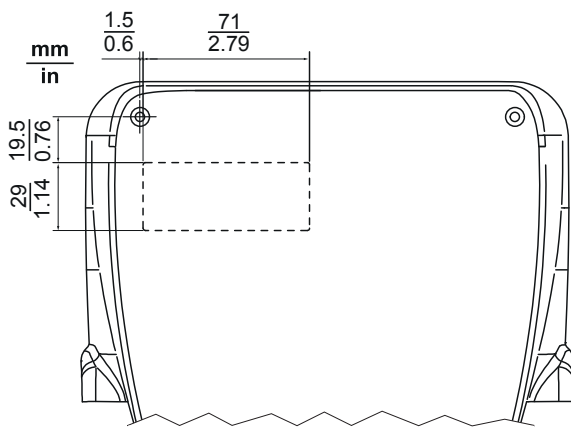

FRONT VIEW

Installation

⚠️ DANGER

RISK OF ELECTRIC SHOCK, EXPLOSION OR ELECTRIC ARC

Final application must prevent access to dangerous live parts through the opening made for housing cards or electronic devices as the box does not offer protection against these cases.

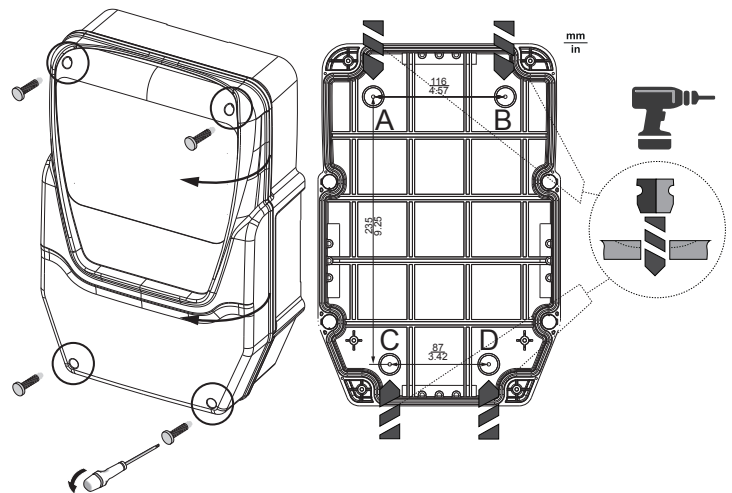

Failure to follow these instructions will result in death or serious injury.



Assembly instructions

1. Remove the screws (self-tapping 3.5x32 TC head) securing the cap at the top and then open the cover;
2. Drill holes for the high and low voltage cable glands on the sides of the backplate, as shown in the figure. Check that the cables are inside the box. Use suitable cable clamps / pipe clamps guaranteeing the sealed closure of all wiring;
3. Drill 4 holes (see A...D) in the wall and fix the backplate in place using 4 screws (not supplied) suited to the wall thickness;
4. Insert plug covers TDI 20 (accessory available on request);
5. Close the door and re-tighten the 4 cover screws making sure that the hinges are flush and do not interfere with the closure of the cover. Hinges are available for mounting on special compartments for opening the cover both right and left.

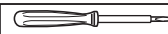
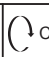
Screw on the respective anchoring screws taking care that the hinges are fitted well and lie flush so that they do not interfere with the compression of the seal.

		N•m	0.5...0.6
Ø 3.5 mm (0.14 in.)		lb-in	4.42...5.31

Hinge fitting instructions

1. Open the 4 hinge closing screws;
2. Fit the hinges firmly in the compartments in the cover and the backplate;
3. Re-tighten the 4 hinge screws to fix them firmly to the plastic.

Dimensions

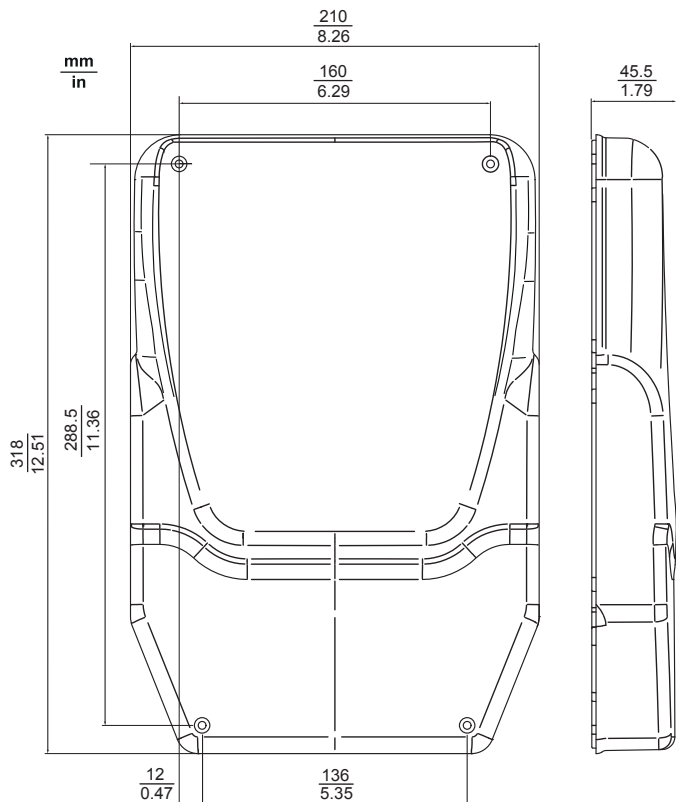

FRONT VIEW

Technical Data (IEC62208)	
Use	Manufacture of electrical panels in conformity with standard EN61439-1
IP protection rating (IEC60529)	IP65 (Only version with blind top cover without millings)
IK protection rating (IEC62262)	IK08 (Only version with blind top cover without millings)
Dimensions	Front 210x318 mm (8.26x12.51 in.) Depth 102 mm (4.01 in.)
Assembly methods	On wall in vertical position
Operating temperature	-5 ... 35 °C (23 ... 95 °F)
Nominal isolation voltage of casing	Double isolation (box only without holes); TDI 20 protection for screws (accessory available on request).

CONDITIONS OF USE

Permitted use

For permitted uses, refer to standard EN61439-1.

Prohibited use

Any use other than that expressly permitted is prohibited.

LIABILITY AND RESIDUAL RISKS

ELIWELL CONTROLS S.R.L. accepts no responsibility for loss/damage due to:

- installation/uses other than those expressly specified and, in particular, failure to comply with the safety requirements of established standards and/or instructions specified in this document;
- use on panels that do not provide adequate protection against electric shocks, water or dust when assembled;
- use on panels allowing access to dangerous parts without having to use tools;
- tampering with and/or modification of the product;
- installation/use on panels which are not compliant with current standards and regulations

DISCLAIMER

This document is the exclusive property of ELIWELL CONTROLS S.R.L. and may not be reproduced or circulated without the express permission of ELIWELL CONTROLS S.R.L. While all possible care has been taken to ensure the accuracy of this document, ELIWELL CONTROLS S.R.L. cannot accept liability for any damage resulting from its use.

The same applies to any person or company involved in preparing and editing this document.

ELIWELL CONTROLS S.R.L. reserves the right to make changes or improvements at any time without notice.

DISPOSAL

The equipment (or product) must be subjected to separate waste collection in compliance with the local legislation on waste disposal.

Eliwell Controls s.r.l.

Via dell'Industria, 15 • Z.I. Paludi
32010 Pieve d'Alpago (BL) - ITALY

T: +39 0437 986 111

F: +39 0437 989 066

www.eliwell.com

Technical Customer Support:

T: +39 0437 986 300

E: Techsuppeliwell@schneider-electric.com

Sales:

T: +39 0437 986 100 (Italy)

T: +39 0437 986 200 (other countries)

E: saleseliwell@schneider-electric.com



code 9IS54507 • EWBOX SMALL • EN • rel. 09/16

© Copyright Eliwell Controls s.r.l. 2016 • All rights reserved.